

Taking measurements

Line: Measure a single distance (length, width, height etc)

Click on Line on the toolbar and click on either end of the measurement.

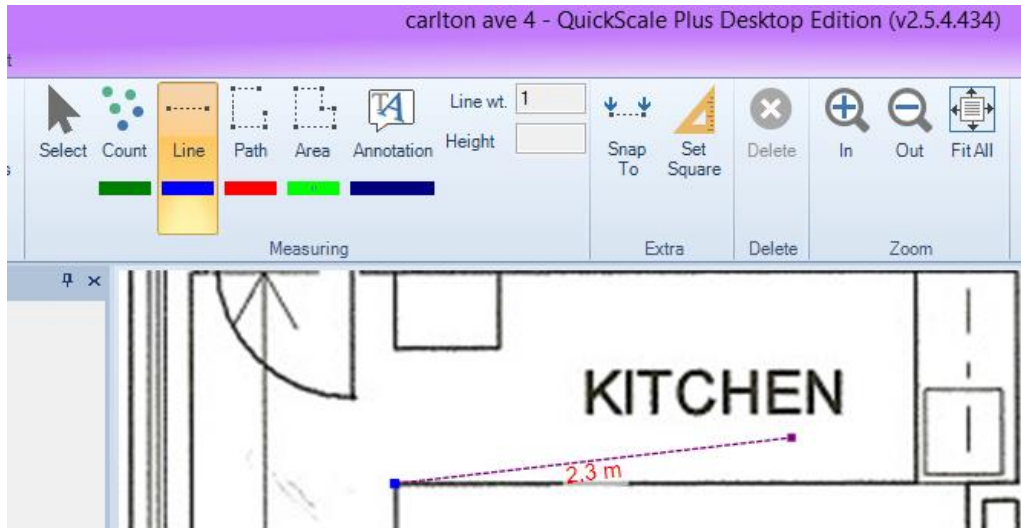

Path: Measure a continuous distance (perimeter, skirting, fire escape runs etc)

Click on Path on the toolbar then click on all the points along that path.

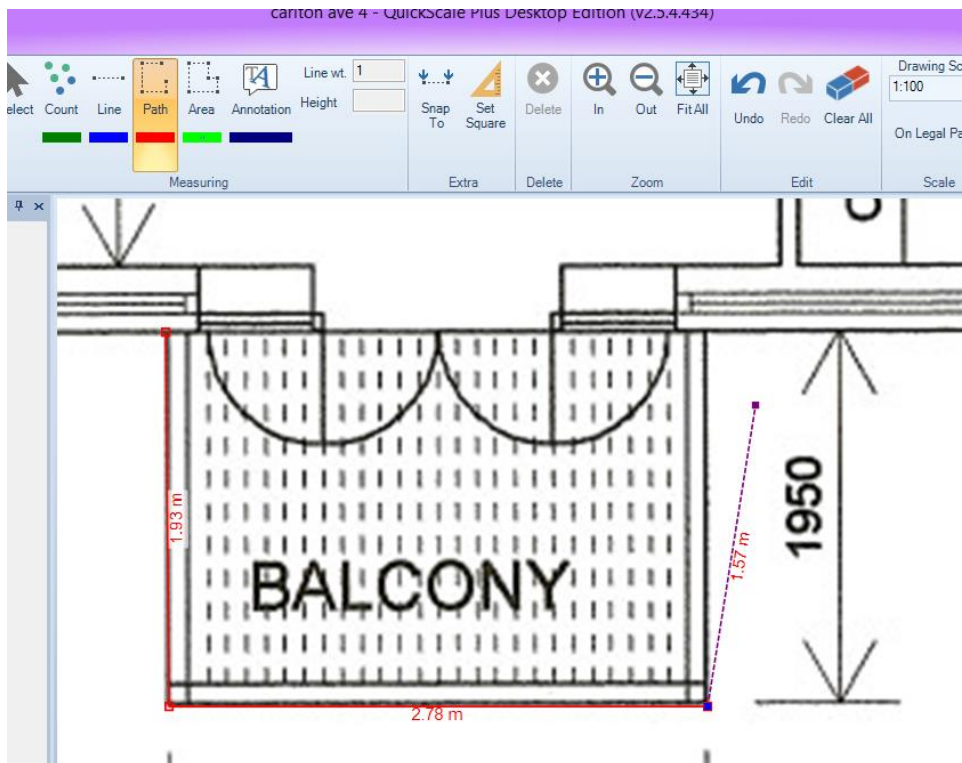

To finish the measurement, right click on the last point and click on Complete.

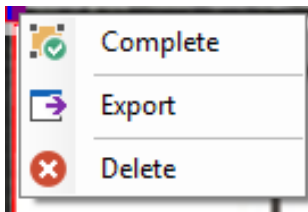

Area:

Click on Area on the toolbar then click on all the points/corners/curves along the edge of that area.

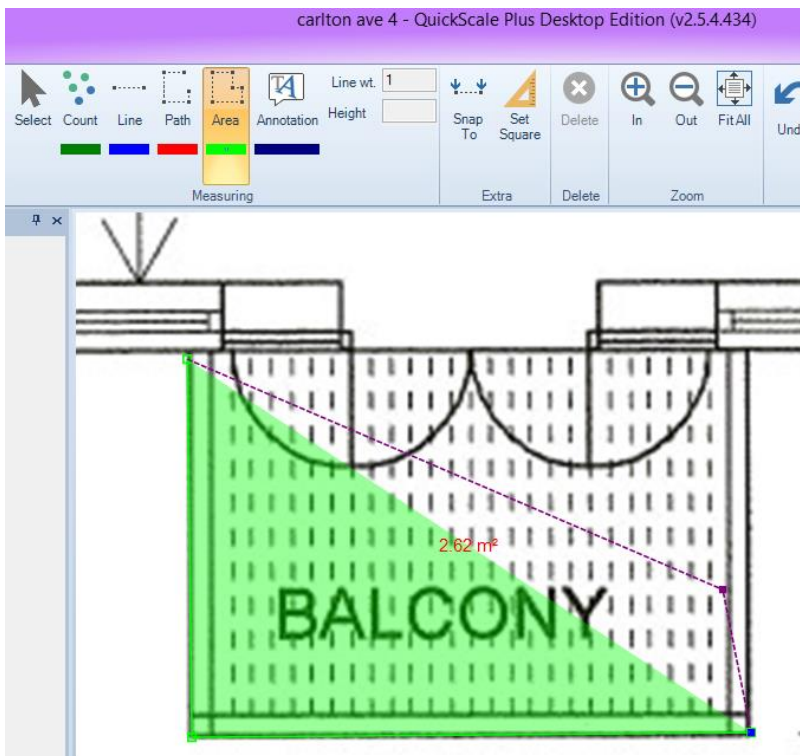

To finish the area, the last point click must be the same as the first point click

Kind regards

The QuickScale Team
sales@quickscale.co