

Add/insert a point to a Path or Area (Plus edition only)

Add point will add to the end of the path or area

Insert point will insert anywhere in the middle of the path or area

Insert a point:

Click on **Select** on the tool bar and click on the edge of the area where the point is to be inserted. The edge will turn blue.

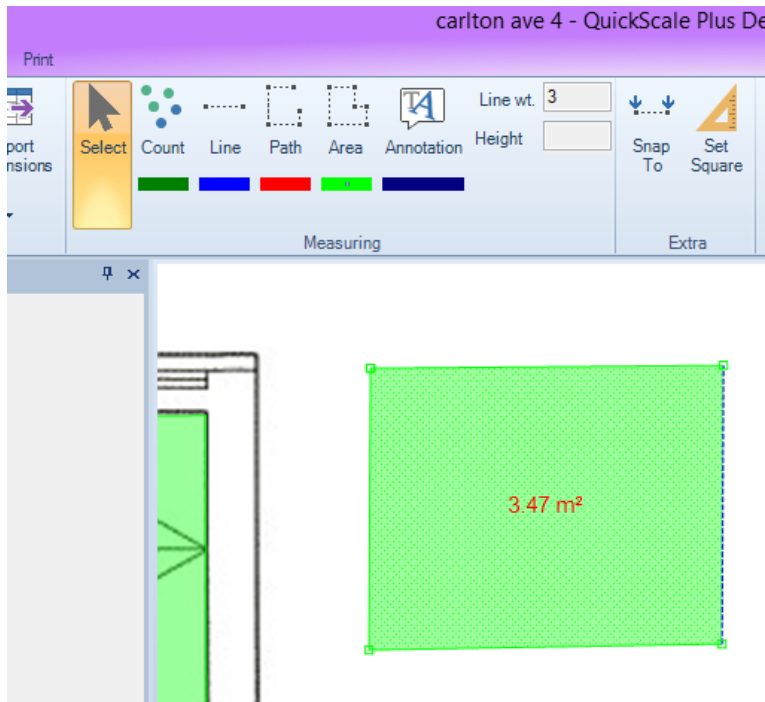

Right click on the blue edge and select **Insert Point**.

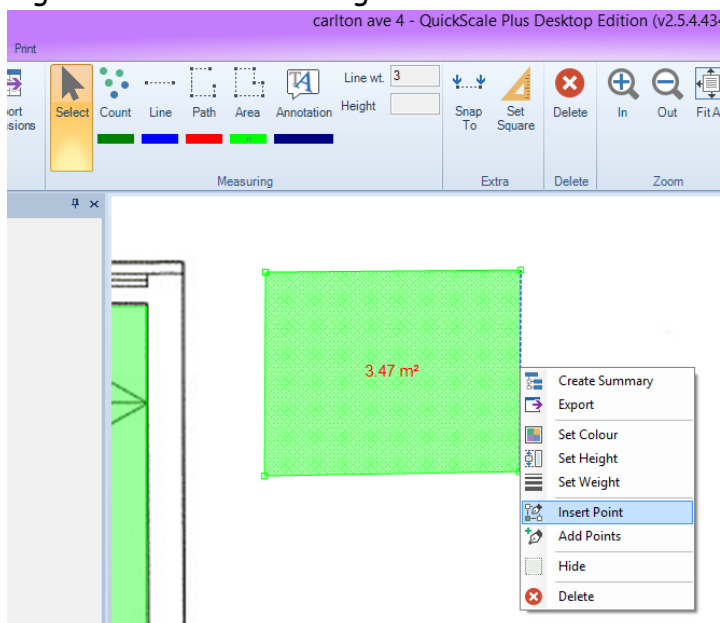

Click on the drawing where the new point is to go

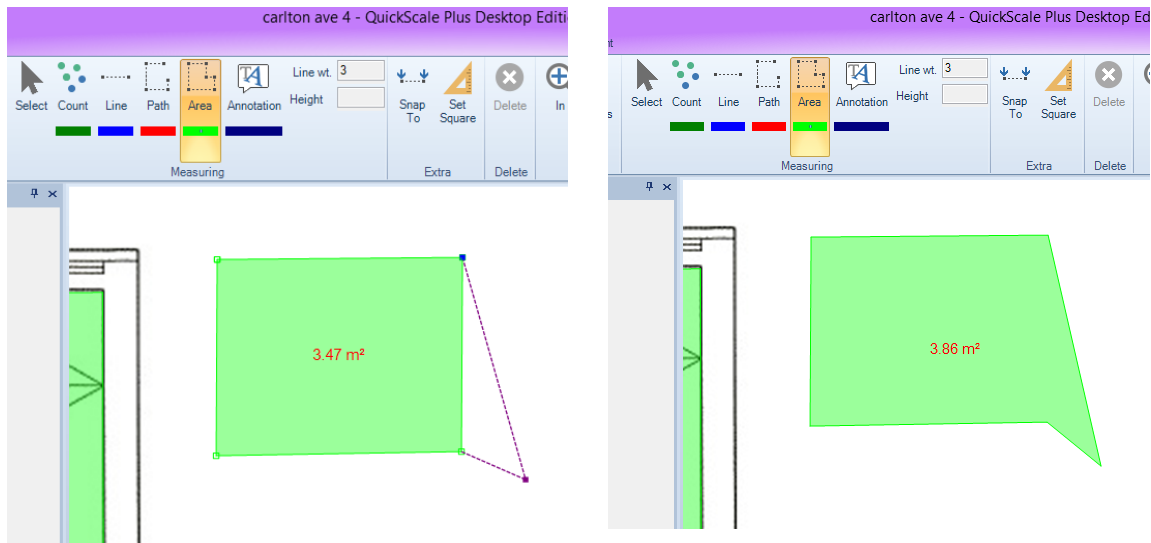

Add point(s):

Click on Select on the tool bar and right click on the Path. The last section of the Path will turn blue. Click Add Points.

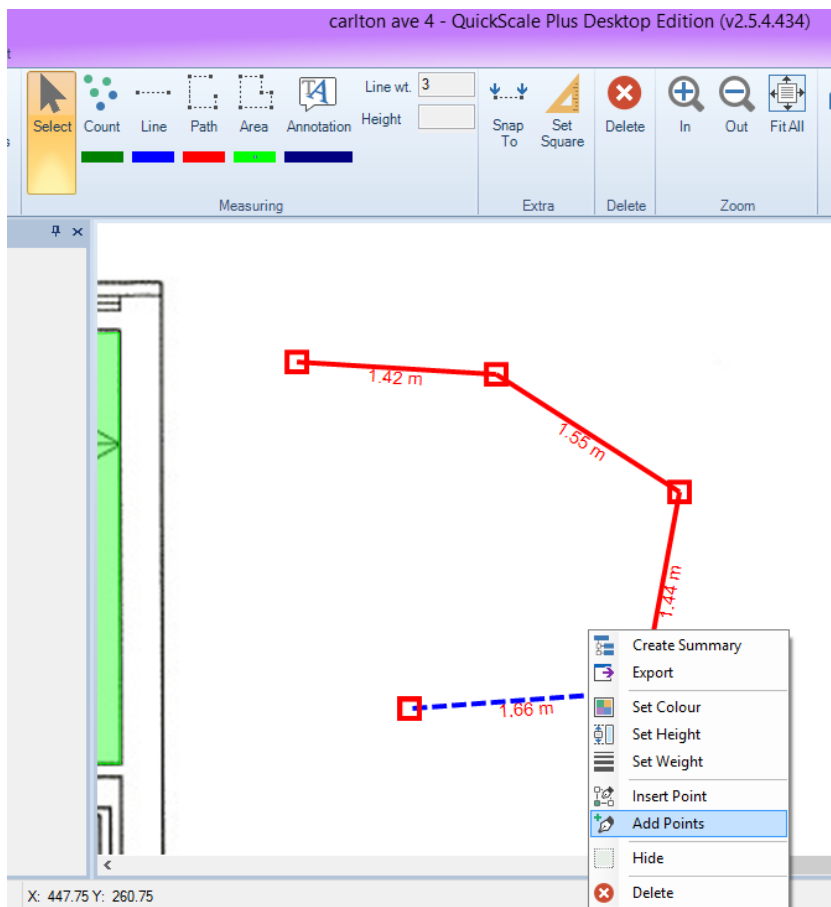

Click on the drawing where the new points should be. When finished, right click and select Complete.

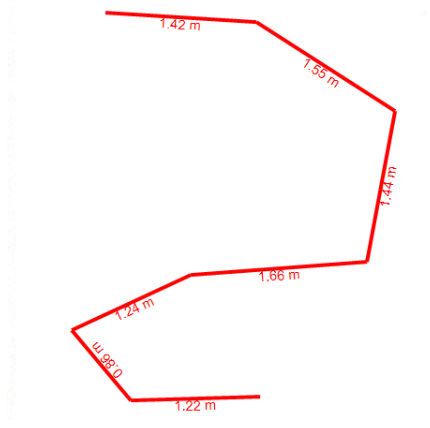
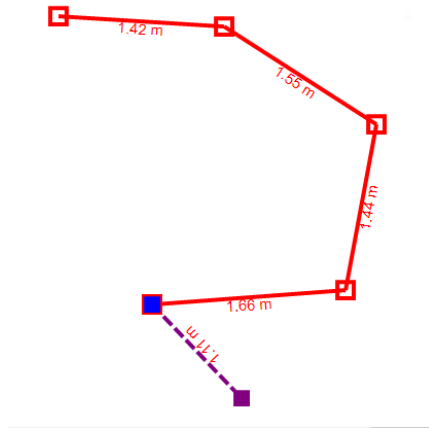

Kind regards

The QuickScale Team

sales@quickscale.co